

FENNELL CAMPUS MASTER PLAN

CAMPUS DESIGN CONCEPT

The physical Campus Master Plan vision for Fennell reflects a beautiful, welcoming and transparent environment defined by unique and inviting open spaces and buildings, distinct iconic architecture and art and an energy generated by pedestrian movement and activity. It is a vibrant and inclusive place that engages the college community as well as the neighbouring community—residents, the hospital, the school, the City of Hamilton—year-round and in all seasons. It is an exceptional teaching and learning environment in which pedagogy is reflected in the buildings, landscapes and art both internally and externally. Fennell Campus is a place that inspires, that visibly showcases leadership in sustainability and technology, with growing gardens, forested canopies and photovoltaics absorbing energy. The campus is pedestrian. It is a place with a multitude of pathways and connections that encourages a seamless flow of movement from internal to external, from edge of campus to internal campus, weaving through and linking a diversity of social spaces and distinct campus neighbourhoods.

The Campus is defined by three distinct land areas, the east campus, the west campus and the North Lands, the latter referred to in this document as the “Potential Campus.” Although there is ample room for future build-out of the Fennell Campus, the Campus Master Plan focuses on a compact approach to development reflecting a 20–30 year planning horizon. In this timeframe, the emphasis of growth and development is on the east campus, with enhancements to the west campus and the north Potential Campus. Development of the west campus area fits within a longer term planning horizon in which the lands are held as a land bank for future growth and development. In the shorter planning horizon, surface parking lots remain to facilitate parking but also to function as a forum for sustainable initiatives. The Campus Master Plan as such, builds on the existing campus structure, which celebrates existing assets, enhances sustainability, creates distinct and inclusive places for teaching, learning, socialization, recreation, health and wellness and community integration.





FENNEL CAMPUS CONCEPT PLAN

BUILT FORM:

- ① to ⑤ Future Buildings (New Bld.)
- ⑥ to ⑫ Future Expansions (BE)

PUBLIC REALM:

- Ⓐ Transit Hub and Indigenous Garden
- Ⓑ East Main Plaza
- Ⓒ Central Plaza
- Ⓓ East Orchard
- Ⓔ West Orchard
- Ⓕ Rooftop Community Garden
- Ⓖ Courts
- Ⓗ The I Wing Pond
- Ⓘ Greenhouse & Gardens
- Ⓝ The Cellar Plaza
- Ⓚ Forest
- Ⓛ Botanical/Wellness Gardens
- Ⓜ Community Field
- Ⓝ Community Trails
- Ⓞ Streetscape Enhancements

OTHER:

- - - Property Line
- - - Potential Campus Property Line
- [T] Surface Parking
- improved walkways throughout

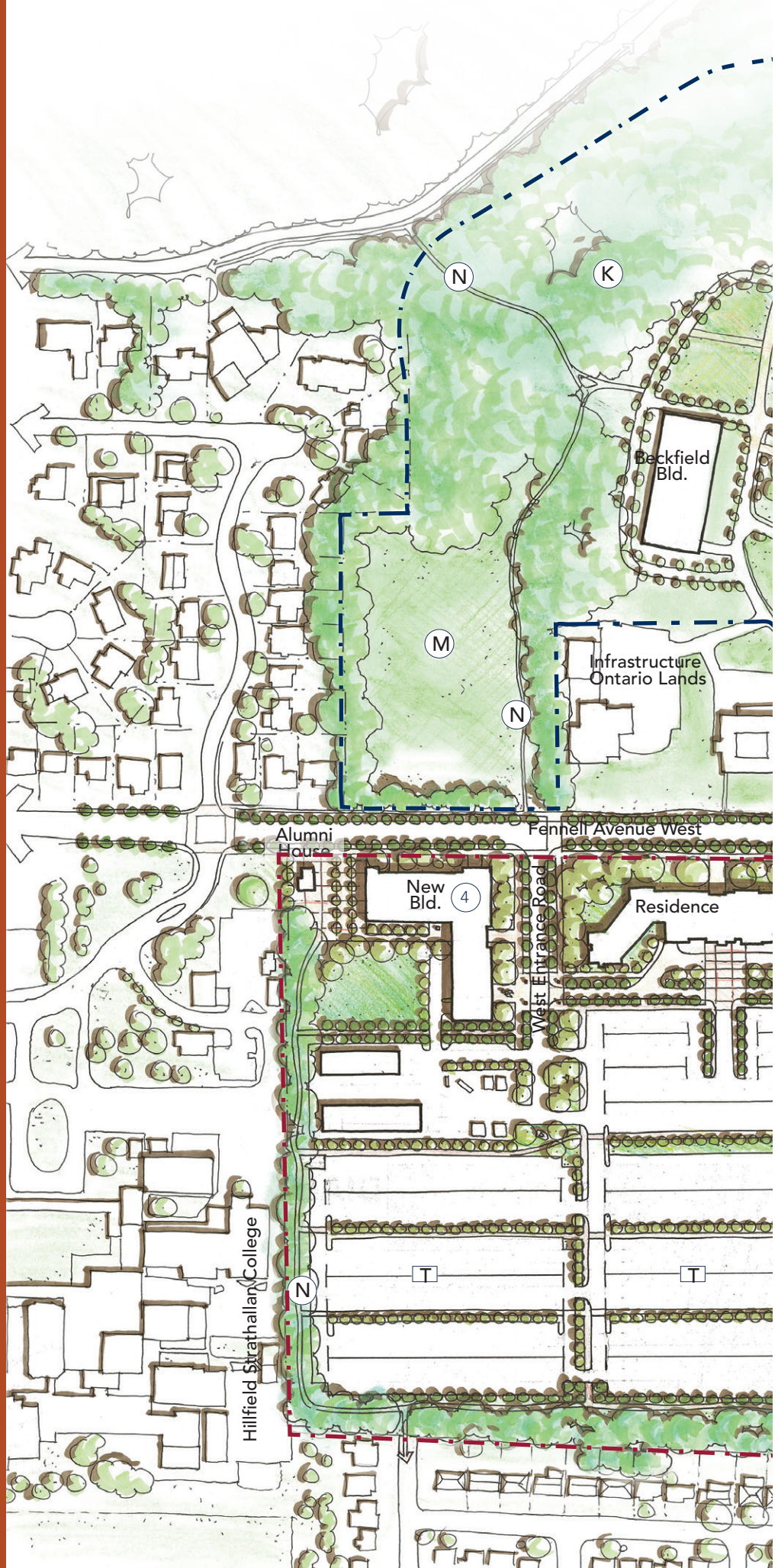

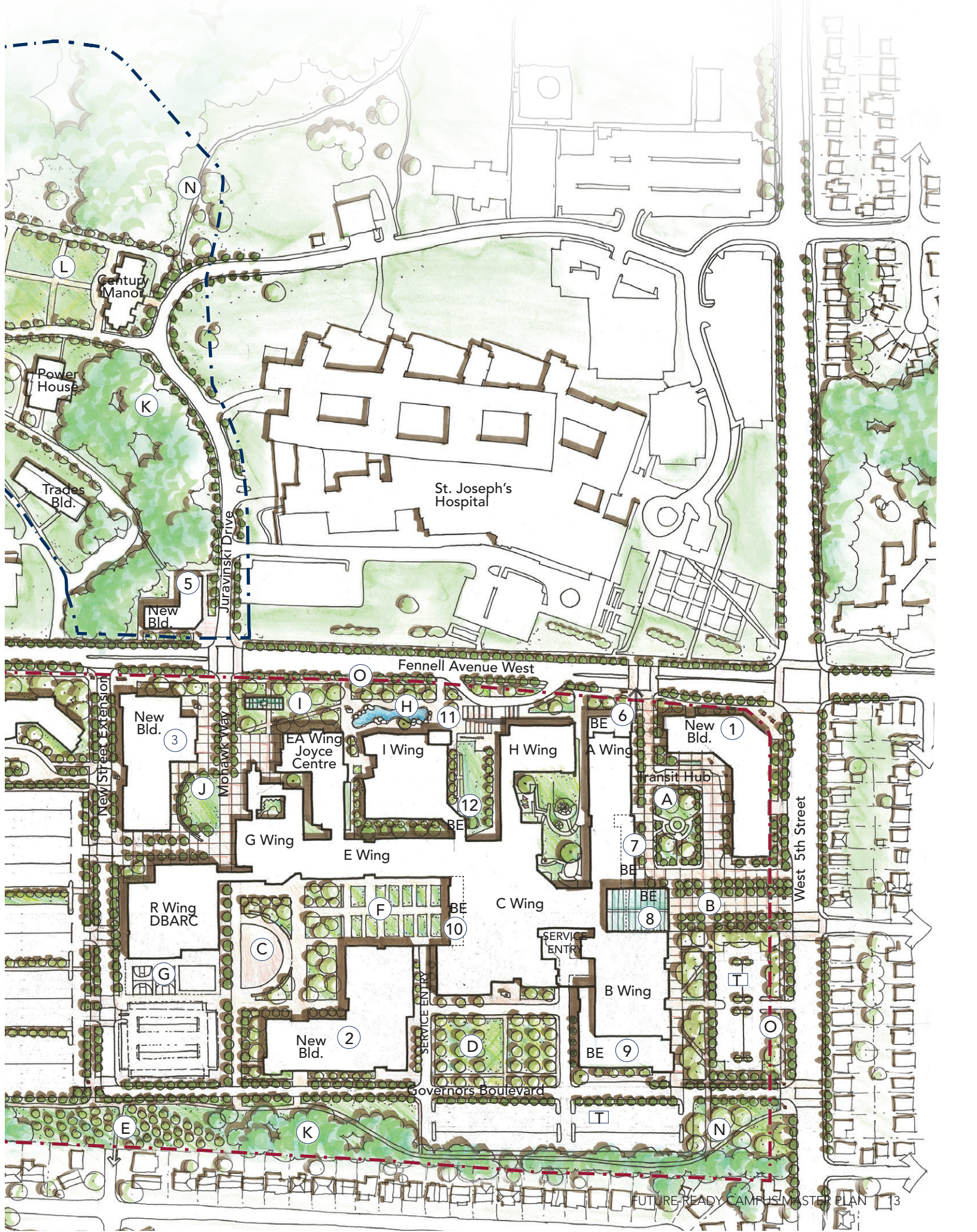

THE FENNEL CAMPUS NEIGHBOURHOODS

The campus is best described by its unique campus neighbourhoods. This structure emphasizes the approach to creating distinct places on campus – a collection of interconnected destinations that builds campus placemaking and identity. The approach allows for clarity and guidance in decision making in terms of the appropriate location of uses and the function, design and programming of buildings, spaces, streets and pathways. Each neighbourhood is defined by buildings and open spaces focused around a central gathering place or hub, both internal and external. This creates a selection of places to go to gather, socialize, integrate and experience the unique aspect or draw of each place, creating “social magnets” at each corner of

the campus. The unique features of each area are enhanced and celebrated, whether it is an open space, a building, a heritage feature, or special street. Each neighbourhood can also be defined by specific uses and functions, or by the academic contribution to place – a focus on technology or athletics, or a grouping of residences, a celebration of Indigenous culture, or the primary gateway to the campus. Although each neighbourhood can be defined by the strength of an academic program, it should be designed to reflect and accommodate a mix of uses and programs to build in long term flexibility and to futureproof the campus. Each campus neighbourhood is described below in detail, from east campus to west campus and to the North Lands.

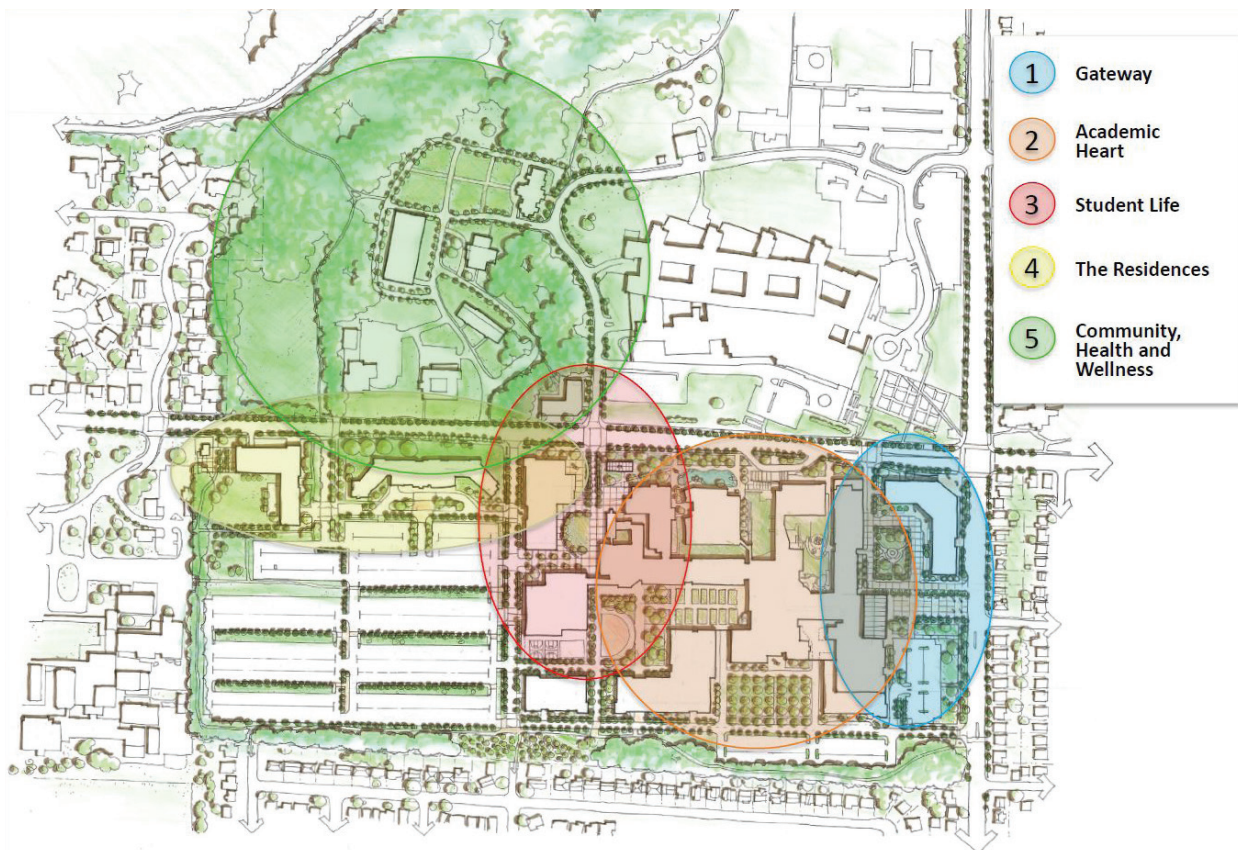

Fennell Campus Neighbourhoods

THE GATEWAY NEIGHBOURHOOD

The Gateway Neighbourhood is one of the most important places on campus as it is meant to function as the primary face of the campus to the community. It is the main front door at the most public of intersections. It is designed as a dynamic and animated place reflecting the hustle and bustle of the college community as it meets the city and neighbouring community. It is the transfer point and confluence between campus and city, engaging city transit and pedestrian movement internally and externally to the campus. The Front Gateway Neighbourhood needs to be carefully designed and well thought out as it is the place to go as a visitor and newcomer to the campus, where you are introduced to Fennell campus, become versed in the wayfinding of place, experience the welcoming amenities and are immediately immersed in the vibrancy that defines the campus.

ACADEMIC HEART NEIGHBOURHOOD

The Academic Heart Neighbourhood functions as the internal engine of the campus and as the primary student hub. The heart of this neighbourhood is primarily focused on the internal spaces as the magnet, showcasing a diversity of organized existing and new social gathering and amenity space destinations including the theatre, the Square, the bookstore, cafes and more, all connected by a generous and centralized circulation network. The amenities and services are student focused, catering primarily to student needs and the enhancement of day-to-day student life.

STUDENT LIFE NEIGHBOURHOOD

The Student Life Neighbourhood is a very special area on campus. It is positioned at the “new” centre and crossroads of the campus and will be enhanced even more so as the campus continues to grow west and connect north. Similar to the Academic Heart, the Student Life Neighbourhood is intended to be very student oriented, but the focus is more external. This Neighbourhood is well positioned to be the place to showcase the progressiveness of the campus externally and

to the community, focusing on state-of-the-art buildings and programs such as sustainability and athletics, supported by high-quality open spaces. In the heart of this environment are the MSA and Cellar Buildings which function as the magnets and the energy of the Neighbourhood.

THE RESIDENCES NEIGHBOURHOOD

The Residences Neighbourhood is primarily defined by existing and new student residences that front Fennell Avenue West, which are supported by expansive green landscapes, treed street connections and linked pedestrian pathways. The focus of this Neighbourhood is to create an attractive, green and welcoming environment that functions as a home away from home for students but also as an attractive environment for conferences, hotelling and other related functions. The new residential building is also an opportunity to add a mix of uses to the northwest area of the campus, building on the existing conference facilities and amenities.

COMMUNITY HEALTH AND WELLNESS NEIGHBOURHOOD

The Community Health and Wellness Neighbourhood constitutes the potential campus in the North Lands. The proximity of the lands located next to the hospital east, the escarpment north and the residential community west positions this neighbourhood as a place that represents and fosters campus and community health and wellness. Its many assets such as the recreational fields and enhanced trails, the connection to the escarpment and the forest and the botanical gardens that celebrate a new re-purposed Century Manor all contribute the sense of place defined by health and wellness. It is envisioned as a place of visible pedagogy, a learning and teaching environment in which the re-purposing of the buildings with new programs and uses and the design of the landscape with teaching and food gardens, can contribute to building the identity of Mohawk as a healthy, learner-centred, sustainable and resilient community-oriented college.

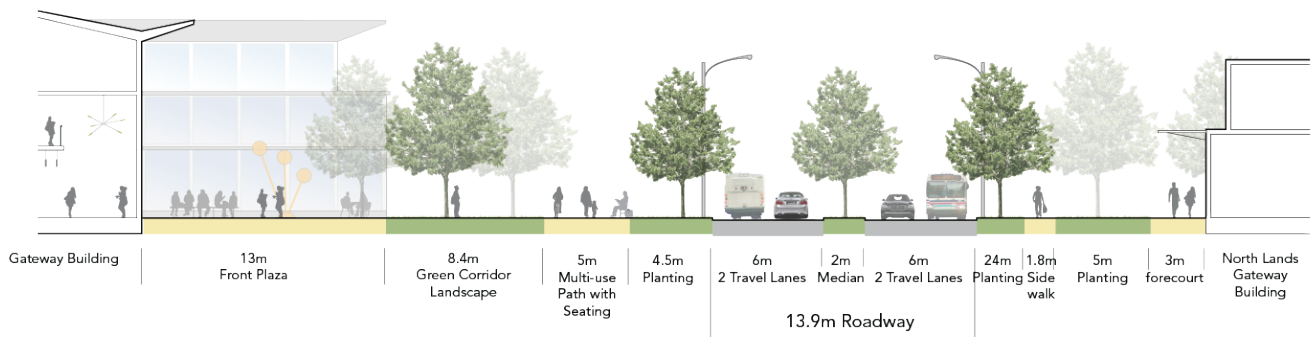

Section-Elevation A–A': Fennell Avenue West, looking west

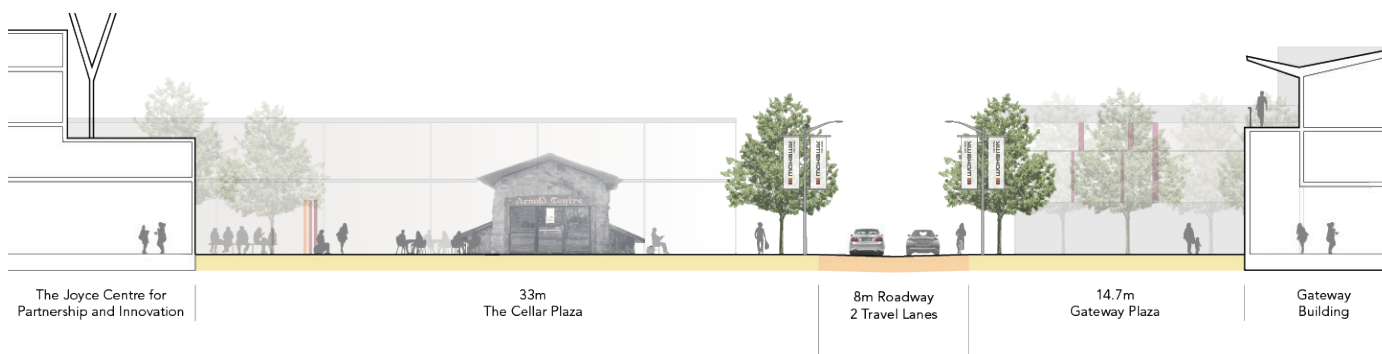

Section-Elevation B–B': Roadway demonstrates typical plaza streets

Streetscape Enhancements

The streetscapes of Fennell Avenue West and West 5th Street are envisioned to enhance primarily in the design of the public realm and the series of adjoining open spaces that together create a welcoming place for the community. The design of the streets themselves will follow the City of Hamilton’s direction to create the character of an Urban Avenue and to incorporate cycling opportunities and accommodate transit stops with bus amenities.

CONCEPT RENDERINGS



Rendered view of the Central Four Corners Gateway into campus, looking southward along Mohawk Way.



Rendered view of the Central Plaza with Agri-gardens, looking east towards the McIntyre Performing Arts Centre.



Rendered view of the East Plaza and Indigenous Square, looking west towards the new East Atrium addition onto the C Wing.